





11 BL

主任	担当	計算	点検
			

街 廓 原 子 一 覽 表 用 紙 (No. 11.)

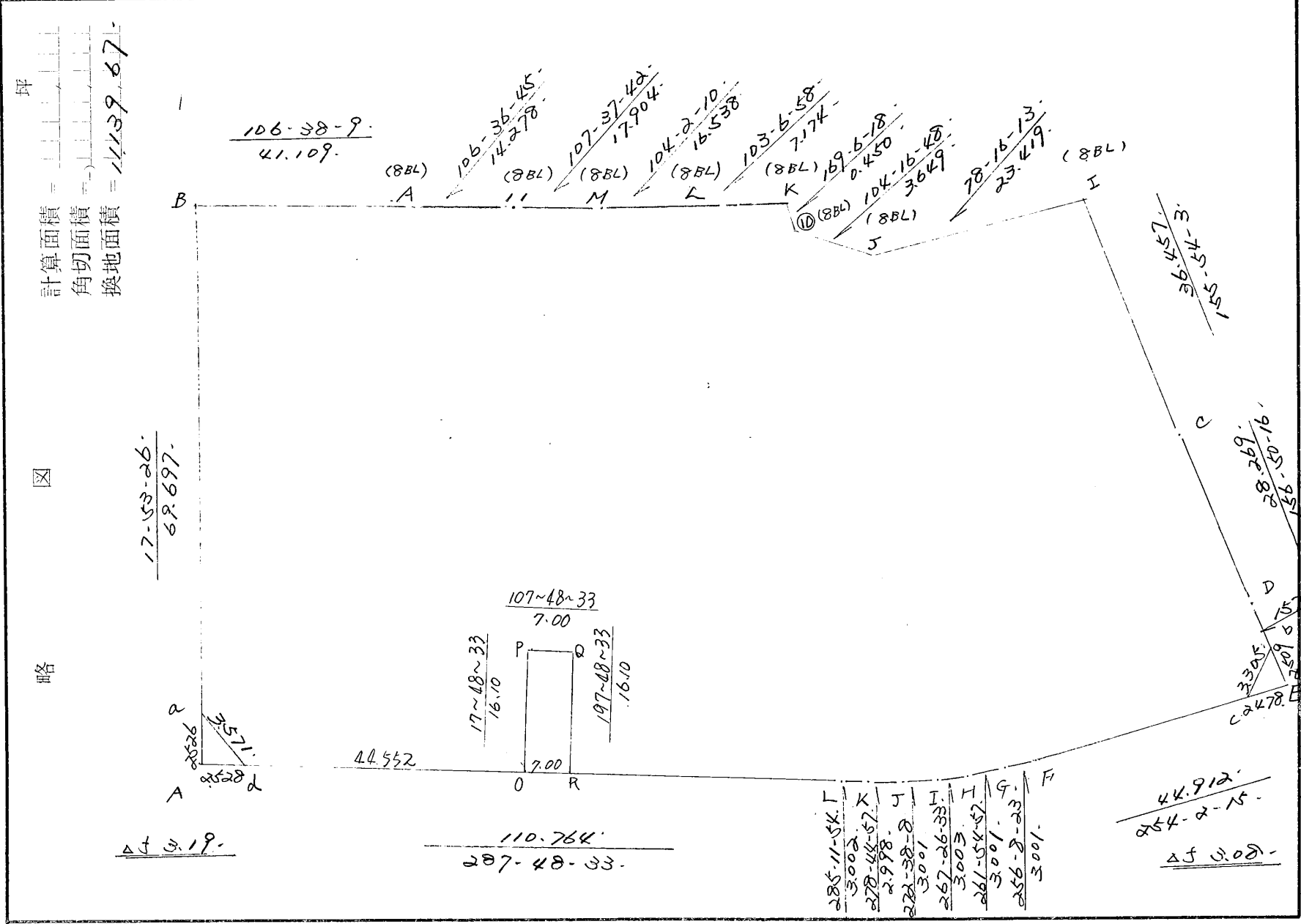

街角点座標及街区面積計算簿

11BL

点	方向角	距離	(1) ΔX	ΔY	X	Y	(2) 複経距	(1) \times (2)
a					4342.341	70126.459		
B	17-53-26	69.697	66.327	21.411	4276.014	70105.048	21.411	1420.127
8BL-A	106-38-09	41.109	11.769	39.388	4287.783	70065.660	82.210	967.529
8BL-11	106-36-45	14.278	4.082	13.682	4291.865	70051.978	135.280	552.212
8BL-M	107-37-42	17.904	5.422	17.063	4297.287	70034.915	166.025	900.187
8BL-L	104-02-10	16.538	4.011	16.044	4301.298	70018.871	199.132	798.718
8BL-K	103-06-58	7.174	1.628	6.987	4302.926	70011.884	222.163	361.681
8BL-10	169-06-18	0.450	0.442	0.085	4303.368	70011.799	229.235	101.321
8BL-J	104-16-48	3.649	0.900	3.536	4304.268	70008.263	232.856	209.570
8BL-I	78-16-13	23.419	4.761	22.930	4299.507	69985.333	259.322	1234.632
C	155-54-03	36.457	33.279	14.886	4332.786	69970.447	297.138	9888.455
D	156-50-16	28.269	25.990	11.119	4358.776	69959.328	323.143	8398.486
b	157-01-22	5.846	5.382	2.282	4364.158	69957.046	336.544	1811.279
c	205-07-22	3.305	2.992	1.403	4367.150	69958.449	337.423	1009.569
F	254-02-15	44.912	12.351	43.180	4379.501	70001.629	292.840	3616.866
G	256-08-23	3.001	0.719	2.914	4380.220	70004.543	246.746	177.410
H	261-54-57	3.001	0.422	2.971	4380.642	70007.514	240.861	101.643
							倍面積	
							面積	

多角測量計算簿

11BL

測点 № 測站	視点	実測角	配賦	方向角	距離	△X	配賦	△Y	配賦	X	Y	測点 №
A5	A6			156-29-22 ✓						4327.911-	69972.062-	A6
A6	C	185-11-05 ✓		161-40-27	5.135 ✓	4.875-		1.615		4332.786-	69970.447-	C
A6	A7			156-45-08 ✓						4370.715-	69953.676-	A7
A7	D	357-54-45 ✓		334-39-53	13.209 ✓	11.939		5.652-		4358.776-	69959.328-	D
C26	C26-1			280-25-12 ✓						4275.622-	70106.545-	C26-1
C26-1	B	4-15-45 ✓		104-40-57	1.548 ✓	0.392-		1.497		4276.014-	70105.048-	B
A7	A37			258-35-15 ✓						4383.106-	70015.062-	A37
A37	F	356-23-25 ✓		74-58-40	13.908 ✓	3.605		13.433		4379.501-	70001.629-	F
"	G	356-04-05 ✓		74-39-20	10.908 ✓	2.886		10.519		4380.220-	70004.543-	G
"	H	353-20-05 ✓		71-55-20	7.940 ✓	2.464		7.548		4380.642-	70007.514-	H
"	I	344-17-10 ✓		62-52-25	5.110 ✓	2.330		4.548		4380.776-	70010.514-	I
"	J	313-32-40 ✓		32-07-55	2.915 ✓	2.468		1.550		4380.638-	70013.512-	J
"	K	255-37-20 ✓		334-12-35	3.248 ✓	2.924		1.413-		4380.182-	70016.475-	K
"	L	232-08-25 ✓		310-43-40	5.688 ✓	3.711		4.310-		4379.395-	70019.372-	L

多角測量計算簿

11BL

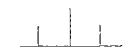

測点 №		実測角	配賦	方向角	距離	ΔX	配賦	ΔY	配賦	X	Y	測点 №
測站	視点											
A36	A35-1			289-00-09 ✓						4344.752-	70127.277-	A35-1
A35-1	d	358-22-05 ✓		107-22-14	2.566 ✓	0.766-		2.449		4345.518-	70124.828-	d
"	a	269-44-30 ✓		18-44-39	2.546 ✓	2.411		0.818		4342.341-	70126.459-	a
A6	A7			156-45-08 ✓						4370.715-	69953.676-	A7
A7	b	356-02-35 ✓		332-47-43	7.372 ✓	6.557		3.370-		4364.158-	69957.046-	b
"	c	330-00-20 ✓		306-45-28	5.958 ✓	3.565		4.773-		4367.150-	69958.449-	c

交点座標計算用紙

11BL

	Xi	Yi	ΔX	ΔY	方向角	距離
P ₁ (a) =	4342.341-	70126.459-		P ₁ → P =	197-53-26	求点 (A)
P ₃ (d) =	4345.518-	70124.828-		P ₃ → P =	287-48-33	
求点P(A) =	4344.745-	70127.235-				
P ₁ (a) → P(A)			2.404-	0.776-	197-53-24	2.526
P ₃ (d) → P(A)			0.773	2.407-	287-48-15	2.528
P ₂ () → P()						
P ₄ () → P()						
P ₁ (b) =	4364.158-	69957.046-		P ₁ → P =	157-01-22	求点 (E)
P ₃ (c) =	4367.150-	69958.449-		P ₃ → P =	74-02-15	
求点P(E) =	4366.468-	69956.067-				
P ₁ (b) → P(E)			2.310-	0.979	157-01-56	2.509
P ₃ (c) → P(E)			0.682	2.382	74-01-22	2.478
P ₂ () → P()						
P ₄ () → P()						

