

附近見取図

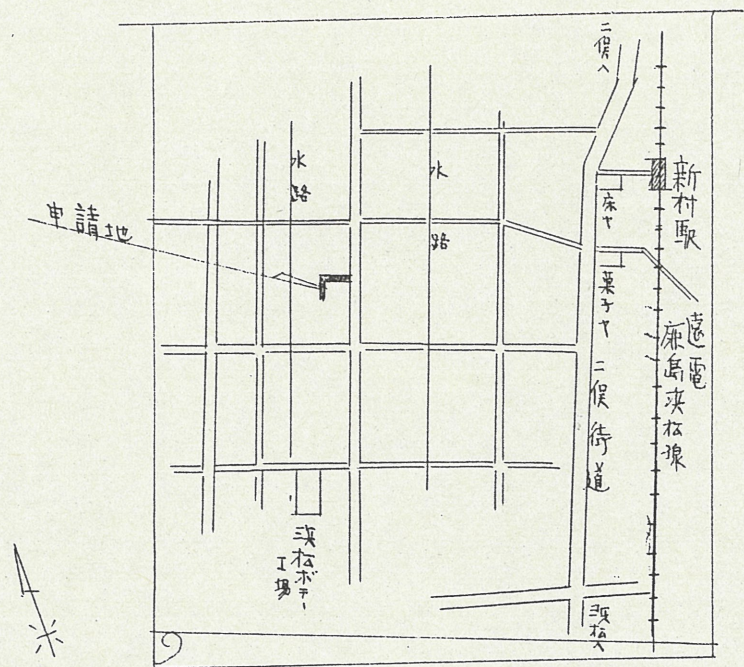

公図写 $\frac{1}{600}$

断面図

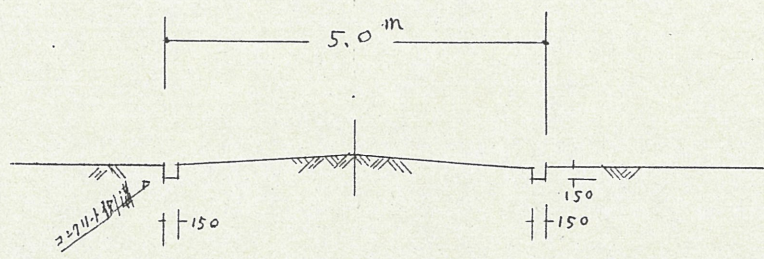

実測図 $\frac{1}{300}$

道路位置指定図	指定番号	42-45
有玉北町 地内	指定年月日	S42. 8.10

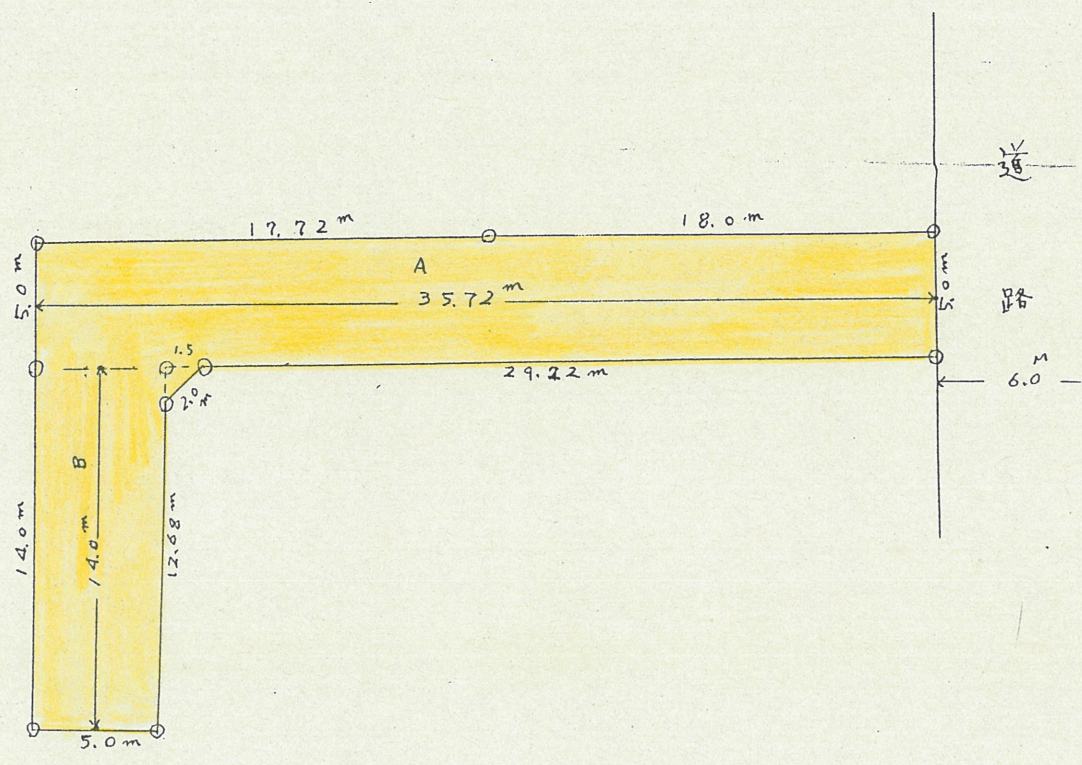
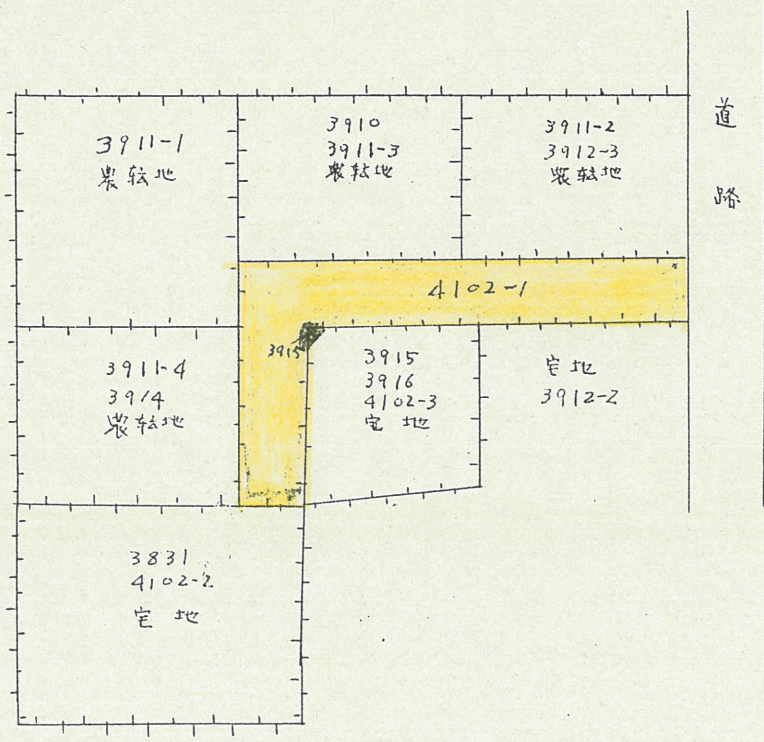

$A + B = 35.72 + 14.0 = 49.72^m$

附近見取図

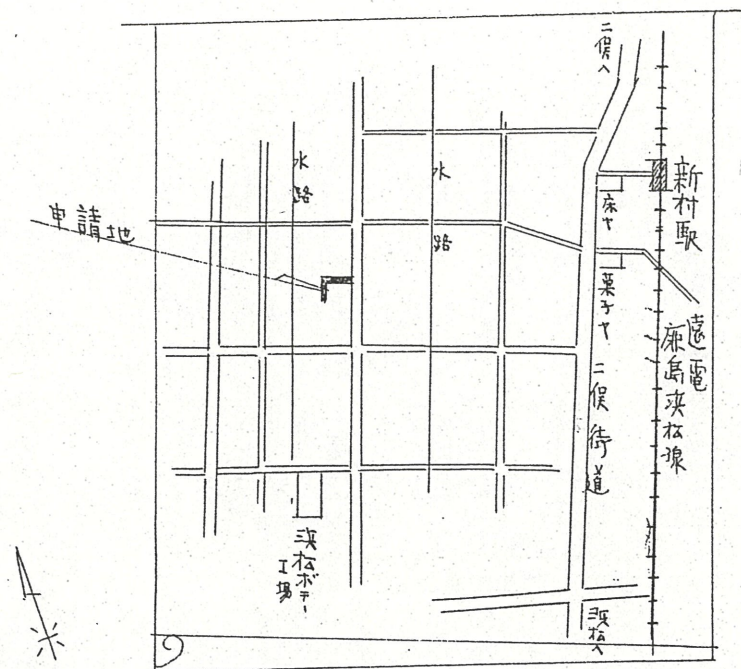

公図写 $\frac{1}{600}$

断面図

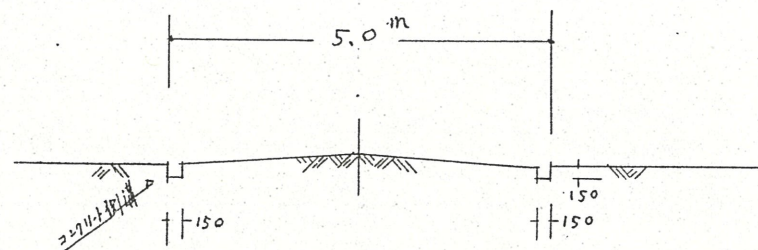

実測図 $\frac{1}{300}$

道路位置指定図	指定番号	42-45
有玉北町 地内	指定年月日	S42. 8.10

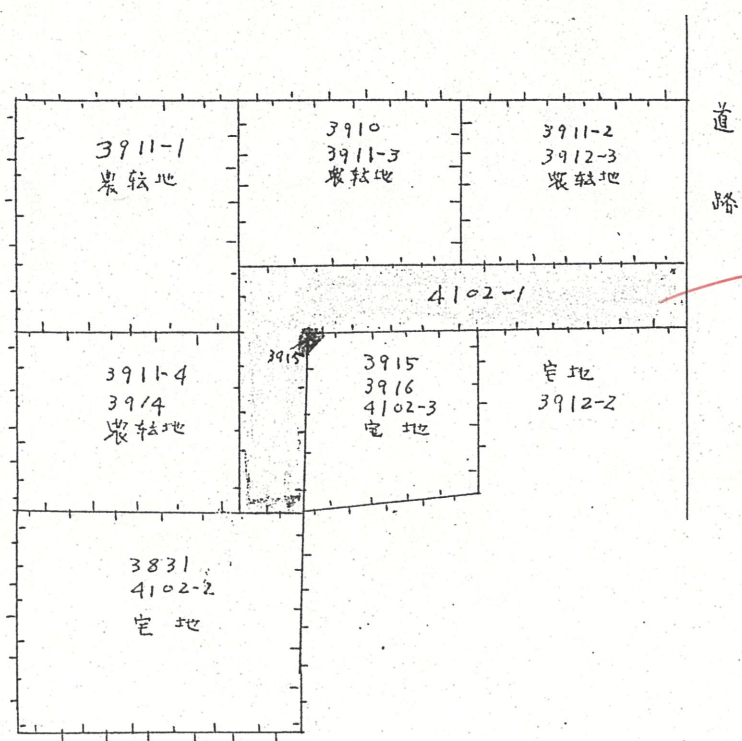

S44
土地改良
換地後
1679㎡変更

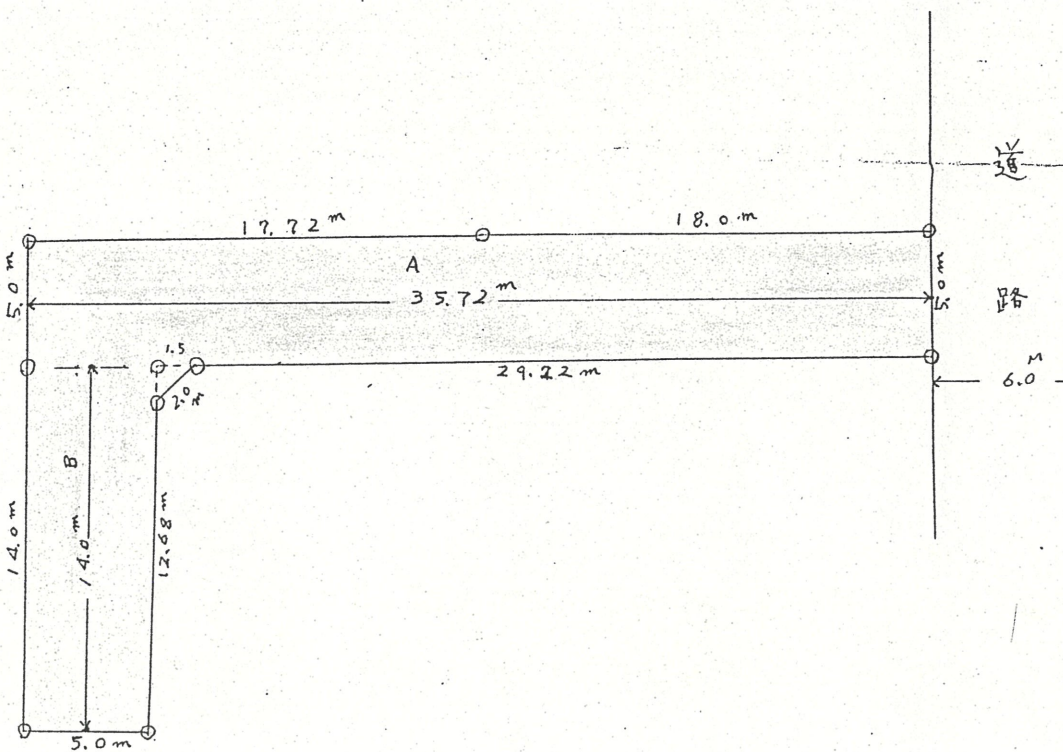

$A + B = 35.72 + 14.0 = 49.72 \text{ m}$